

**Mortairvent® CW | Full-Wall Mortar Deflection & Rainscreen Technology for Masonry Cavity Wall Applications**

**DESCRIPTION**

The Mortairvent® CW Mortar Deflection & Ventilation System is a full cavity wall product that combines the benefits of rainscreen technology through the use of integrated mortar deflection, drainage and ventilation design. The result is an easy to install system that improves the overall performance of the interior wythe while also providing drainage and ventilation for the entire cavity wall.

Mortairvent® CW is available with a mortar deflection fabric or without depending upon the specific design recommendations of the project. The bonded mortar deflection fabric option provides an additional layer of prevention against mortar blockage of the cavity wall drainage plane and provides a dedicated airspace for ventilation and convective drying.

**BENEFITS**

- » Improves the overall performance of the entire cavity wall assembly
- » Maintains a continuous airspace between the outer masonry wall and weather resistant barrier to facilitate moisture drainage and drying
- » Optional mortar deflection fabric layer provides a dedicated airspace for ventilation and convective drying
- » 16" wide material is lightweight and easy to install between brick ties. Provides simple one-step installation as brickwork is completed
- » Mold & mildew resistant

**INSTALLATION INSTRUCTIONS**

- » Apply a water resistant barrier over sidewall sheeting. Note: Some regions may require two weather resistant barriers. Check local codes for more information.
- » Install Mortairvent® CW over installed rigid foam insulation board. Starting at the base of the wall unroll Mortairvent® CW from right to left between brick anchors with the three-dimensional (blue) polymer matrix side against the water resistant barrier and mortar deflection fabric facing exterior of building. Unroll the next course in the same manner as the first.
- » Be sure to always butt the blue polymer material together without overlapping.
- » Mortairvent® CW should be installed horizontally between brick ties as exterior brickwork is completed so as to maintain captivation within the brick anchoring system.

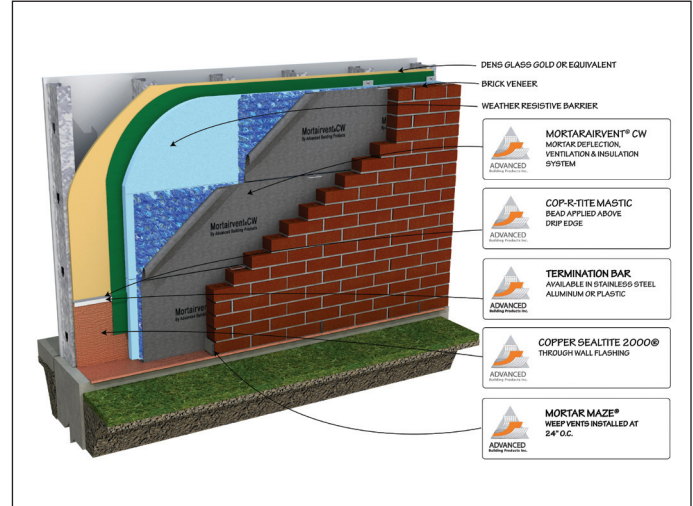

Mortairvent® CW is easy installed by simply rolling the product horizontally between the brick ties.

**TECHNICAL DATA**

Mortar Deflection, Ventilation, &amp; Drainage Mat Options

**Mortairvent 205****Mortairvent 206**

	<b>Mortairvent 205</b>	<b>Mortairvent 206</b>
Mortar Deflection & Ventilation Material Thickness	.40 in. (10 mm)	.80 in. (20 mm)
Density / Specific Gravity (ASTM D 792, Method A)	0.908 g/cm <sup>3</sup>	1.216 g/cm <sup>3</sup>
Porosity (open space) ECTCTASC00197)	95.6 %	97.7 %
Mass / Unit Area (composite) (ASTM D 5261 / D 6566	13.42 oz/sq.yd	12.15 oz/sq.yd
Hydraulic Transmissivity (ASTM D 4716)	5.56 gpm/ft width	12.00 gpm/ft width
Air Transmissivity (ASTM D 4716, mod)	14.9 cu.ft/min/ft width	89.5 cu.ft/min/ft width

**ADVANCED BUILDING PRODUCTS INC.**

Phone: 800-252-2306

Fax: 207-490-2998

info@advancedflashing.com

www.advancedflashing.com

