



# Termination Bars

Specification Bulletin  
No. 402

Termination Bars®

## Termination Bars |

### Description:

#### Stainless Steel Termination Bars:

Stainless Steel Termination Bars are 1" wide, with .100" thickness, and length is 8'-0". Holes are 8" on center.

#### Aluminum Termination Bars:

Aluminum (Alloy 6063) Termination Bars are 1" wide, with .090" thickness, and length is 10'-0". Holes are 8" on center.

#### Plastic Termination Bars:

PVC Termination Bars are 1" x 8', with a thickness of .125". Plastic Termination Bars can be custom cut to size and easily fastened on the job site.

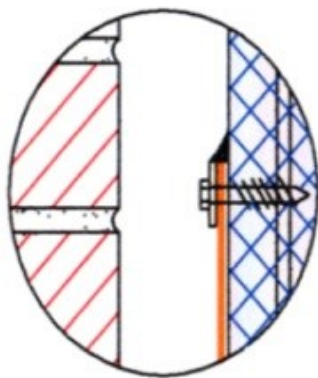
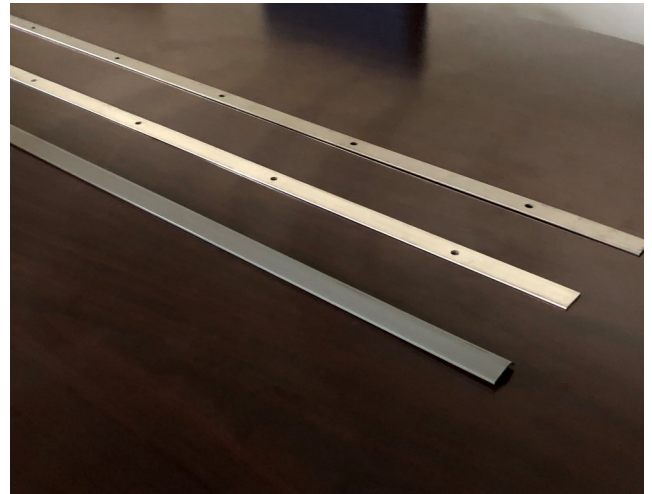

FLASHING SECURED WITH A  
TERMINATION BAR

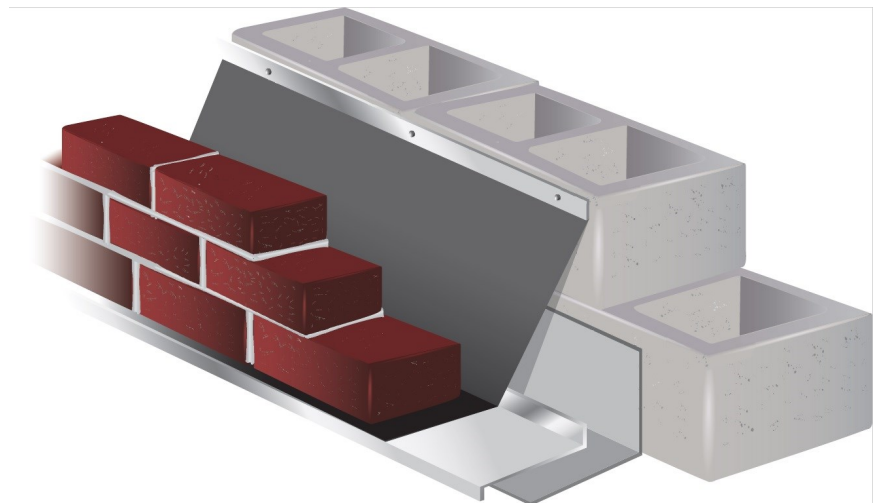

**ADVANCED BUILDING PRODUCTS, INC.**  
Phone: 800-252-2306 Fax: 207-490-2998  
info@abp-1.com www.advancedbuildingproducts.com

