



Termination Bars

Specification Bulletin
No. 402

Termination Bars®

Termination Bars |

Description:

Stainless Steel Termination Bars:

Stainless Steel Termination Bars are 1" wide, with .100" thickness, and length is 8'-0". Holes are 8" on center.

Pieces Per Box: 25, Lineal Feet Per Box: 200

Aluminum Termination Bars:

Aluminum (Alloy 6063) Termination Bars are 1" wide, with .090" thickness, and length is 10'-0". Holes are 8" on center.

Pieces Per Box: 50, Lineal Feet Per Box:: 500

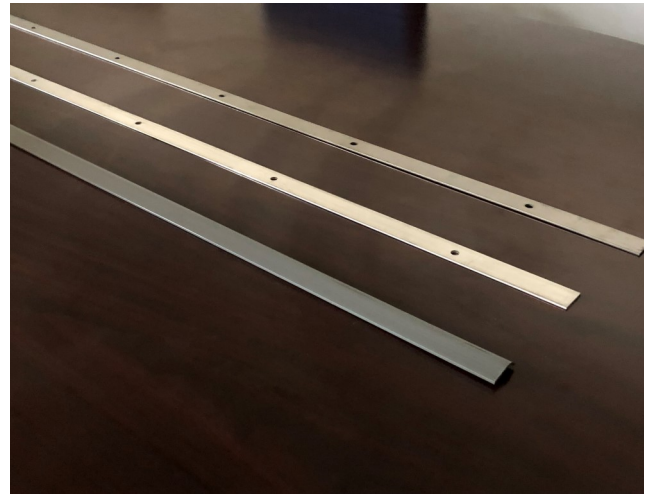

Plastic Termination Bars:

PVC Termination Bars are 1" x 8', with a thickness of .125". Plastic Termination Bars can be custom cut to size and easily fastened on the job site.

Pieces Per Box: 25, Lineal Feet Per Box: 200

* 8000 Lineal Feet / Pallet, 10,000 Lineal Feet += Volume quantity

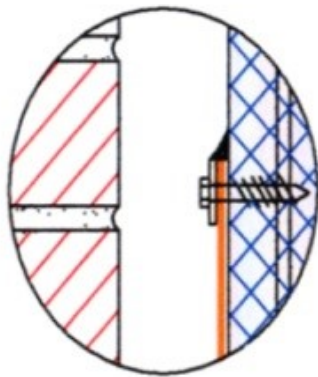

FLASHING SECURED WITH A
TERMINATION BAR

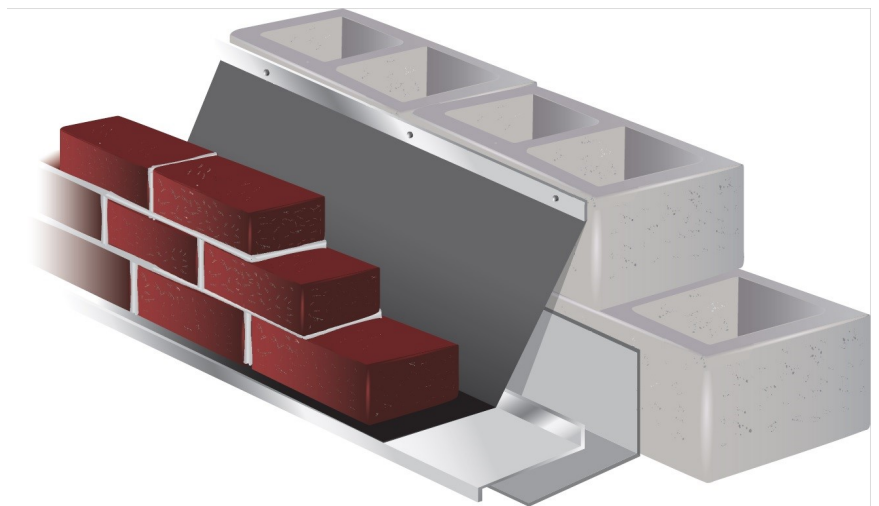

ADVANCED BUILDING PRODUCTS, INC.
Phone: 800-252-2306 Fax: 207-490-2998
info@abp-1.com www.advancedbuildingproducts.com

